



US9425739 (01-22)

Operator's Manual & Parts List

425, 425-101, 425-Prof, 475-B, 475-101, 475-Prof, 435, 485, 473-P, 473-D, 473-ECS, 425-Deluxe, 475-B-Deluxe, 425-HD, 475-B-HD, 315-A



If you are missing parts, instructions or have questions, DO NOT return this unit back to the store. Call 1-800-SOLO-INC (1-800-765-6462). Solo will send the missing parts/information to you promptly.

WARRANTY:

Solo backpack sprayers are covered by Solo's 1-YEAR LIMITED WARRANTY. Solo manufactured parts which fail due to defective material or workmanship will be repaired or replaced without charge. See page 5 for full details and complete warranty information.

MAINTENANCE TIP: The cap gasket (#4061345 or #4061346) is pre-lubricated for improved sealing. Occasional lubrication with Solo Superior Grease (#9850-P) or petroleum jelly is recommended.

SAFETY PRECAUTIONS:

1. Before using sprayer with chemicals, fill sprayer with fresh water to assure that you have it properly assembled; pressurize and practice spraying. Also, check for any leaks at this time. When thoroughly familiar with the sprayer operation, follow normal operating procedures.
2. Ensure all pressure in the sprayer is relieved by locking the shut-off valve in the open position.
3. Avoid contact with chemicals.
4. **Always wear rubber gloves, safety goggles and appropriate protective clothing.**
5. Work in a well-ventilated area.
6. Individuals should be trained in the proper use of this sprayer, chemical handling procedures, and first aid/emergency care. Where training is not available, individuals should study and follow the procedures detailed in this manual.

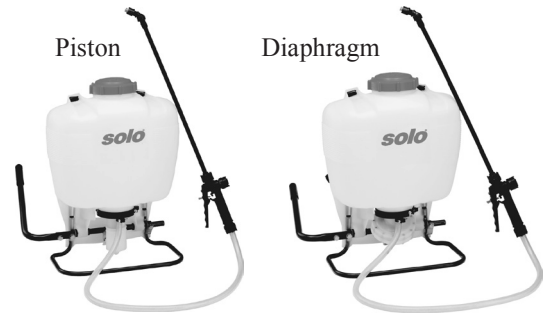

WARNING:

Chemicals can be harmful to individuals and the environment if improperly used. In addition, some chemicals are caustic, corrosive or poisonous and should be avoided. Read warnings and chemical manufacturers' instructions. Solo high density polyethylene sprayers are fitted with chemical resistant seals which are compatible to a wide variety of agricultural and household chemicals; however, care should be exercised to ensure that sprayer components are clean, functioning properly, and in a good state of repair before and during use. If in doubt about a particular chemical, check the manufacturer's instructions or call the manufacturer. If you suspect or observe indications that the material may be unsafe in a Solo sprayer...**STOP. DO NOT USE OR APPLY CHEMICAL. ALWAYS WEAR RUBBER GLOVES, GOGGLES, AND APPROPRIATE PROTECTIVE CLOTHING!**

- Read and follow operating instructions.
- **Do not fill with, use, or spray flammable materials, including Diesel Fuel.**
- Do not modify sprayer.
- Never spray in the direction of humans, animals or property which might be injured or damaged by spray formula.
- Do not use disinfectants, solvents or impregnating agents unless first tested to ensure they are not harmful to the environment or sprayer.
- Do not use liquids with a temperature above 110°F (43°C).
- Wear appropriate protective clothing to prevent contact with chemical agents.
- Rinse and clean sprayer thoroughly after using. Disposal of contaminated rinse should be in accordance with applicable ordinances. Observe the precautionary instructions of the chemical manufacturer.
- **Do not use any acid (including citrus) or caustic chemicals. For bleach solutions, try our Solo 475-B, 475-101, 475-Prof or 475-B Deluxe sprayers.**
- Remember that a sprayer with liquid is a significant amount of weight (8 lbs. per gallon). Do not climb when wearing the sprayer. Use caution when bending, leaning or walking. Bend at the knees rather than the waist.
- During sprayer operation, the pressure cylinder (#4400240) contains compressed air and liquid. Compressed air and liquid under pressure are inherently dangerous. Before making adjustments on sprayers fitted with a pressure regulating valve assembly (#4800182) located on the pressure cylinder or any other repair or inspection of any sprayer, be sure to relieve pressure through the shut-off valve and wand.

CUSTOMER SERVICE COMMITMENT FROM SOLO'S SERVICE DEPARTMENT

In the event the sprayer you have purchased has missing or damaged parts, please call 1-800-765-6462, 9:00 AM - 5:00 PM EST.

In order to assist your service representative, please have the following information available: sprayer model number, part description and part number. A parts list is included in your operator's manual.

Solo is committed to your satisfaction and is continuing its efforts to earn your future business.

Visit us on the web at us.solo.global
Troubleshooting and parts ordering available on-line.

REMOVING PLASTIC ADJUSTABLE NOZZLE

Unscrew the nozzle cap (1) from the nozzle body (3). This is best accomplished while the retaining nut (2) is fastened tightly to the elbow (5). Next, unscrew the retaining nut (2). Push the nozzle body (3) out of the retaining nut (2). The filter with gasket (4) will come out with the body. To reinstall the nozzle, reverse the above instructions.

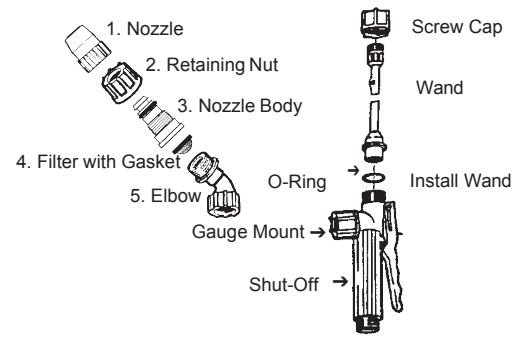

ASSEMBLY INSTRUCTIONS FOR WAND

1. Insert wand into shut-off valve as shown.
2. Tighten the screw cap clockwise onto the shut-off valve.

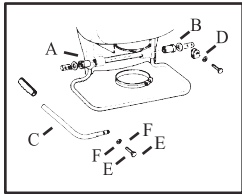

PUMP LEVER INSTALLATION: All hardware necessary for pump lever installation is included with the sprayer. The pump lever (C) should be installed as follows: place lever handle (C) onto the pump shaft (A). Align bolt holes and install the two bolts (E) and washers (F); then tighten. To install pump lever on the opposite side on a Diaphragm Pump sprayer, remove the stop plate (D) and washer. Install the pump lever as above. The stop plate (D) should then be mounted on the inner bolt hole with the closed end of the stop plate pointing downward on the opposite side of the pump shaft.

FOLD-AWAY PUMP HANDLE INSTALLATION (FOR SELECT MODELS ONLY):

1. Remove bolt and nut from pump handle.
2. Slide handle assembly over the pump shaft and align the holes so that the rear (elbow) portion of the handle points up and slightly forward (approximately 45 degrees) and away from the Solo logo. Reinstall bolt and locknut. Pump handle can be installed on the opposite side of the sprayer for right hand pumping. (For Diaphragm Pump Sprayer, stop plate will need to be relocated to the left side.)
3. The handle can be rotated to either down (pumping) or up (storage) positions. Note: The handle swings away from the sprayer, then up or down as desired. The spray wand attaches to the clamps on the handle assembly for storage (does not apply to the brass or stainless steel wands).

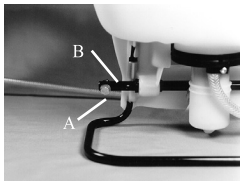

SHOULDER STRAP INSTALLATION:

The top of the shoulder straps are pre-attached to the sprayer by means of a buckle or pin. The lower end of the straps are attached by fastening the strap hooks to the metal frame between where frame exits the plastic tank and where the frame makes a bend.



REGULATING THE PRESSURE: (FOR DELUXE MODELS ONLY)

The Solo backpack sprayer is equipped with a built-in regulator to control output pressure. This regulator is operator adjustable. Make adjustments prior to filling tank. To adjust the regulator, remove the tank cap and the filter basket. Look inside the spray tank; you will see the top of the regulator. There are 4 fingers on the regulator knob. The finger farthest to the left is #1; to the right is #4. They are numbered 1, 2, 3, 4. 1 = 15 psi, 2 = 30 psi, 3 = 45 psi, 4 = 60 psi. The higher the pressure, the more chemical applied from the sprayer in a given amount of time, but the droplets will be smaller with more drift. If the spray pressure must be changed, excess pressure in the pressure cylinder must be released back into the tank through the spray tube. To adjust, push down on the knob and rotate to align the desired number with the alignment pin. To operate the 425-Prof, 435, 425-Deluxe and 425-HD at higher than 60 psi, first release the excess pressure and then replace the pressure control valve with the optional plug (#4200215). Purchased separately.

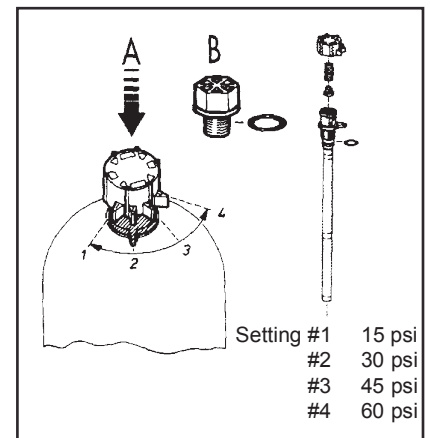





FILLING:

Mix the spray formula and the proper volume of water in a **separate container**. Pour the mix through the filter basket in the tank opening. This keeps debris from entering the sprayer. Pump the sprayer handle to prime the pump and pressurize the pressure cylinder. The volume of liquid in the sprayer tank will appear to decrease as the pressure cylinder is pressurized. Remember that it's not necessary to completely fill the sprayer tank each time. Mix only the amount needed to get the job done. Chemicals **should not** be stored in the sprayer.

Always read and carefully follow the manufacturer's instructions printed on the product label. This can save money and help prevent injury and crop and environmental damage.

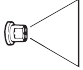
OPERATING FEATURES:

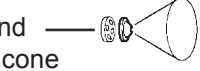
Nozzles - Your Solo sprayer can provide a variety of spray patterns with the standard and optional nozzle arrangements.

Item	Application	Part #
Flat spray nozzle 	Row treatment	4074263
Jet stream nozzle 	Spot & longer range	4074755
Jet stream nozzle and Swirl plate = hollow cone 	Shrubs and bushes	4074755 4074756
Plastic adjustable nozzle 	Spot, shrubs & bushes	4900527
Speed Tip Nozzle 	Row, spot, shrubs & bushes	4074666

*Brass adjustable nozzle and Speed Tip nozzle are not standard items on all Solo sprayers but each may be purchased as an accessory. Spray tips should be assembled as above for desired spray pattern.



WARNING: Handling the brass parts of this product will expose you to lead, a chemical known by the State of California to cause cancer and birth defects or other reproductive harm. Wash hands after handling. For more information, go to www.P65Warnings.ca.gov.

SPRAYING:

Prime the pump with quick pump strokes. When you feel very firm resistance, the pressure chamber is filling with liquid. With repeated piston strokes, the air in the pressure chamber is slowly compressed. In a safe area, point the wand upward and press the shut-off valve lever spraying for 10 seconds or until no air and only liquid is coming out. This will bleed all of the air out of the hose and wand. By pressing the hand lever, the valve opens, and liquid is forced through the nozzle. The shut-off valve has a retaining clip which keeps the valve in the "OPEN" position for continuous operation. Pump using the end of the pump handle, as it is less fatiguing. The volume of liquid delivered varies with the working pressure which should be as high as needed to ensure an adequate spray pattern for each individual application.

NOTE: Should the pressure drop very quickly, drain the tank completely and pump without liquid. By this procedure, the air chamber is refilled with the required volume of air. It is advisable to pump the tank completely empty from time to time.

WETTABLE POWDERS:

Avoid use in piston pump sprayers models 425, 425-101 425-Prof, 425-HD, 315-A, 435, 473-P! The Solo models 475-B, 475-101, 475-Prof, 473-D, 473-ECS, 485 and 475-B-HD sprayers with a diaphragm pump are generally resistant to abrasive materials and are recommended for this purpose. Note: If you use a wettable powder in your 425, 425-101, 425-Prof, 425-HD, 315-A, 435 or 473-P sprayer, be sure that it is thoroughly mixed in the formula solution. Immediately after use, be sure to remove the piston and clean and lubricate the Viton® collar with Solo Superior Grease* or petroleum jelly. **Thorough flushing** of the sprayer will extend the life of its working parts. If you use wettable powders in the piston pump sprayer, be sure to inspect regularly for seepage around the piston, lubricate and/or repair accordingly.

CLEANING:

- After spraying, clean the tank thoroughly. If some spray liquid is left inside, drain tank completely.
- Pumping causes air to be taken in and the remaining liquid to be discharged. Pump until liquid and air are coming out through the nozzle.
- Refill tank with a few quarts of clean, soapy water and pump the water out as explained above (if necessary, repeat this procedure several times).
- If the shut-off valve is removed, the pump can be flushed quickly. Improper spray distribution is the result of a clogged nozzle, which is easily removed and cleaned.
- Soap and water may also be used to clean tank.
- Do not use aggressive cleaning agents or abrasives.
- Follow the recommendations of the chemical manufacturer for disposal of waste water and chemicals.
- Activated charcoal in liquid or other form may be used to absorb chemicals in tanks or spills.

NOTE: When cleaning the sprayer after working with hormone weed killers, follow the instructions of the herbicide producers. Neutralize with activated charcoal. (Example: add 0.35 oz. /1 g. of activated charcoal to 1.7 pint/1 liter of water and leave this detergent in the tank and the lines approximately for 24 hours.) This is very important if other chemicals will be sprayed as the residues of the herbicide may damage susceptible plants. Cleaning after application of products containing carbolineum, a coal tar wood preservative, is imperative. If the chemicals are not water soluble, cleaning should be done with a 5% soda lye having a temperature of 104°F (40°C). Rinse with plenty of clean water.

MAINTENANCE AND STORAGE TIPS:

- After operation, the sprayer should be stored away from direct sunlight to prevent UV damage.
- After removing the pump or when mounting a new Viton® collar, treat both the collar and the piston with water-resistant grease.*
- Before winter, drain all liquid in tank, lines and air chamber. (See “Cleaning.”) **Leave shut-off valve locked in the “open” position to prevent freezing.**
- For service, visit our website to locate your nearest Solo dealer. Always insist on original Solo spare parts.
- Regularly inspect hose, wand, pump, tank and shut-off valve for wear, damage or leaks. Repair promptly.
- Occasionally lubricate cap gasket.*

Avoid excessive wear and prolong sprayer life by:

- 1) Regular lubrication of Viton® collar, cylinder and piston with water-resistant grease.*
- 2) Prompt and thorough cleaning and flushing of sprayer. Soap and water work well.

*Use Solo Superior Grease (#9850-P). Petroleum jelly may also be used

SOLO LIMITED WARRANTY

Solo Incorporated guarantees the original purchaser of Solo equipment that any failure of Solo manufactured parts due to defects in material and workmanship, which occurs during the applicable warranty period, will be repaired or replaced without charge for parts or labor, except for those items not covered by warranty.

CONSUMER LIMITED WARRANTY: Solo equipment purchased for consumer use is covered by this Limited Warranty for a period of ONE (1) YEAR. Solo’s polyethylene tank is covered by this limited warranty for the life of the unit.

COMMERCIAL LIMITED WARRANTY: Solo equipment purchased for commercial use is covered by this Limited Warranty for a period of ONE (1) YEAR.

OWNER’S OBLIGATION AND RESPONSIBILITY: Proof of purchase must be provided by the owner in order to obtain warranty service. Should any failure covered by this Limited Warranty occur, deliver or ship the Solo products or parts to an authorized Solo service center. Freight, packing and insurance costs, if any, will be borne by the owner. Follow normal maintenance service to include applicable lubrication, operation and storage of the product as explained in the operator’s manual.

ITEMS NOT COVERED BY WARRANTY: Provisions of the Limited Warranty will not apply to the following:

- Any indirect or consequential damages that may result from the failure or malfunction of the Solo product.
- Normal service requirements arising during the warranty period, such as cleaning, normal wear, lubrication, filter, spray tips, etc.
- Normal service work over and above the repair or replacement of defective parts. Any failure that results from an accident, customer abuse, normal wear, neglect or failure to operate the product in accordance with the instructions provided in the operator’s manual or provided with the product.
- When an alteration or modification has been performed on a Solo product, Solo is responsible only for products as originally furnished by Solo, provided the alterations or modifications do not adversely affect the product’s operation, performance or durability. Parts or accessories that are incompatible with the product are not approved by Solo.

Full disclosure of Solo’s Limited Warranty is available from your local Solo dealer or SOLO INCORPORATED, 201 Enterprise Drive, Newport News, Virginia 23603 (800-765-6462).

This Limited Warranty gives you specific legal rights and you may also have other rights, which vary from state to state.

Solo’s new Professional sprayers, Models 425-Prof and 475-Prof, are equipped with Solo’s Deluxe Shoulder Saver Harness (part# 4300343) (see below). With its wide, padded straps, chest belt, padded waist belt and lumbar support, this sprayer will remain comfortable to wear even after hours of spraying.

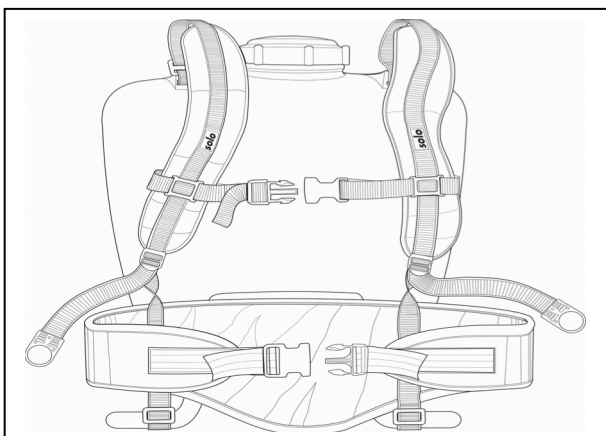

SPARE PARTS LIST

Liste de pièces de rechange
 Lista de piezas de recambio

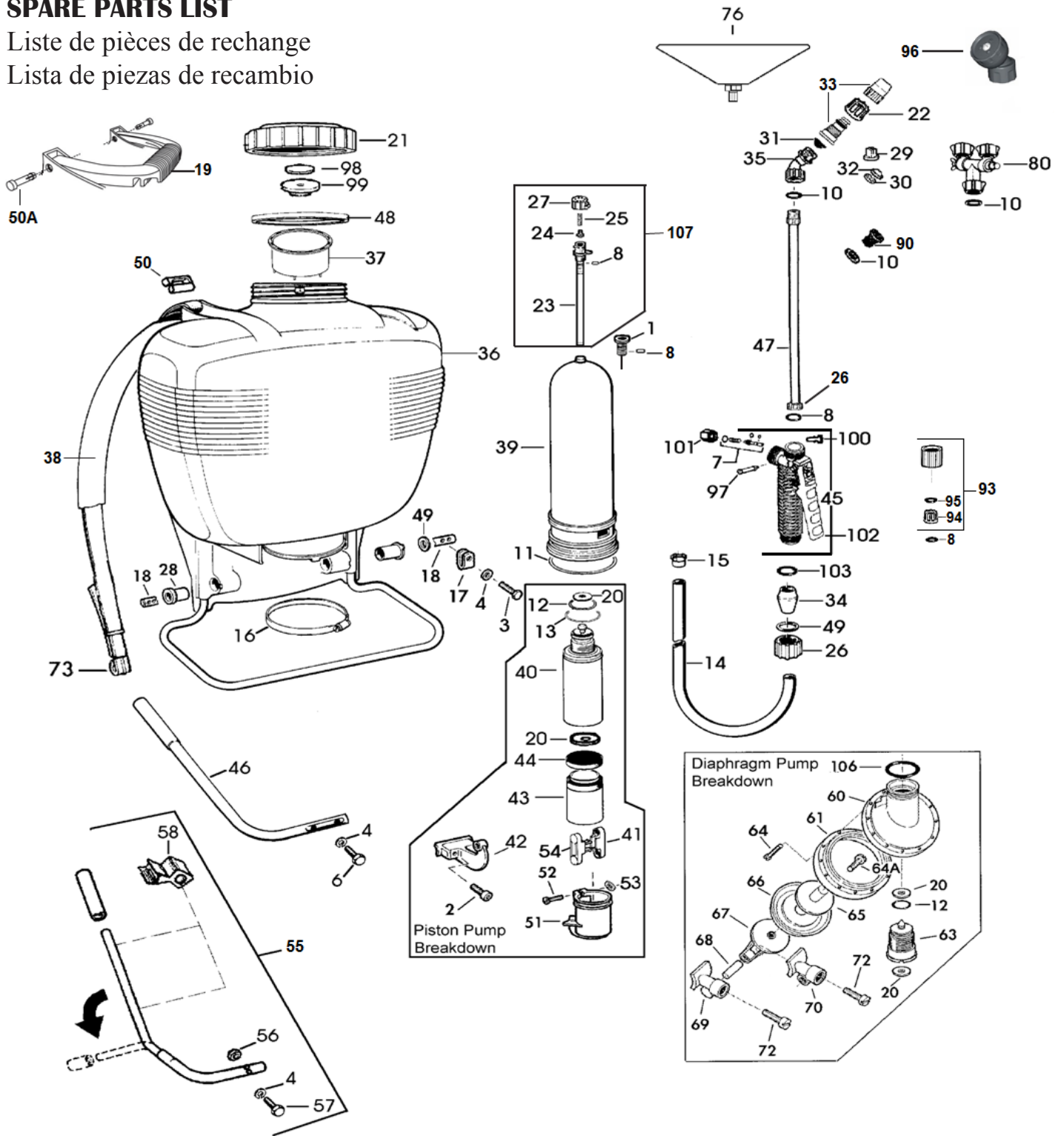

Packaged Kits Not Shown in the Parts List

Order#	Description
0610406-K	Diaphragm pump repair kit includes: 8, 11, 12, 20 (2 ea.), 24, 25, 66, 106
0610407-K	Piston pump repair kit includes: 8, 11-13, 20 (2 ea.), 24, 25, 44
4900200-V	Piston pump repair kit (Viton®/FKM) includes: 8, 11-13, 20 (2 ea.), 24, 25, 44
0610411-K	Wand/Shut-Off Valve repair kit includes: 7, 8, 10, 22, 26, 34, 49, 101, 103
0610409-K	Piston, Rod & Collar kit includes: 2 (2ea.), 41-44, 54
4400203-P	Pump assembly (Piston) includes: 8, 11, 12, 13, 20 (2 ea.), 39, 40, 41, 42, 43, 44, 54, 107
4400221-P	Pump assembly (Diaphragm) includes: 8, 11, 12, 20 (2 ea.), 39, 60, 61, 63, 64 (12 ea.), 64A, 65, 66, 67, 106, 107

POS. #	Order #	For Model	Description	Francais	Español
2	00 10 138		Bolt	Boulon	Tomillo
3	00 12 185		Bolt	Boulon	Tomillo
4	00 30 131		Washer	Rondelle	Arandela
6	00 12 185		Bolt	Boulon	Tomillo
7	06 10 402-K		S shut-off Valve repair kit	Kit de réparation de valve	Kit de reparación de válvulas
-	06 10 413-K	315-A, 475's, 473D, 485	S shut-off Valve repair kit (Viton®)	Kit de réparation de valve (Viton®)	Kit de reparación de válvulas (Viton®)
8	00 62 258		O-ring	Joint bague	Anillo de sellado
10	00 62 115		O-ring	Joint bague	Anillo de sellado
11	00 62 291		O-ring	Joint bague	Anillo de sellado
12	00 62 139		O-ring	Joint bague	Anillo de sellado
13	00 62 140		O-ring	Joint bague	Anillo de sellado
14	00 64 234		Hose 48" (incl. 26, 34, 49, 103)	Tuyau 1,2m (incl. 26, 34, 49, 103)	Manguera 1,2m (incl. 26, 34, 49, 103)
15	00 66 388		Hose clamp	Collier cpl.	Abrazadera
16	00 66 394		Pump clamp	Collier cpl.	Abrazadera
17	40 43 123	475's, 473D, 485	Stop plate	Plaque d'arrêt	Placa de parada
18	40 35 111		Pump shaft	Arbre de pompe	Eje de la bomba
19	40 73 725	101's, Deluxe's, Prof's	Carrying handle (red)	Poignée de transport (rouge)	Asa de transporte (rojo)
-	40 73 727	HD's	Carrying handle (black)	Poignée de transport (noir)	Asa de transporte (negro)
-	40 737 2539	315-A	Carrying handle (blue)	Poignée de transport (bleu)	Asa de transporte (azul)
20	40 61257		Valve plate	Joint de soupape	Sello de válvula
21	42 00 242		Tank cap (red)(incl. 48, 98, 99)	Casquette (rouge)(incl. 48, 98, 99)	Tapa (rojo)(incl. 48, 98, 99)
-	40 73 181	HD's	Tank cap (black)(incl. 48, 98, 99)	Casquette (noir)(incl. 48, 98, 99)	Tapa (negro)(incl. 48, 98, 99)
-	32 00 503	315-A	Tank cap (blue)(incl. 48, 98, 99)	Casquette (bleu)(incl. 48, 98, 99)	Tapa (azul)(incl. 48, 98, 99)
22	40 74 148		Retaining nut	Ecrou de raccord	Tuerca de conexión
23	40 74 323		Valve body	Corps de soupape	Cuerpo de la válvula
24	40 74 350		Sealing plug	Joint	Tapón de sellado
25	00 70 260		Compression spring	Ressort de compression	Resorte de compresion
26	40 74 337		Retaining nut	Ecrou de raccord	Tuerca de conexión
27	40 74 344		Control knob	Bouton de controle	Botón de control
28	40 74 410		Bushing	Coussinet	Cojinete
29	40 74 263		Flatspray jet	Buse à diffusion large	Tobera de chorro ancho
30	40 74 756		Swirl plate	Tourbillon plaque	Placa de remolino
31	40 74 283		Jet filter	Filtre	Filtro
32	40 74 755		Jet cap	Capuchon de gicleur	Caquillo del jet
33	49 00 527		Plastic adjustable nozzle	Buse réglable en plastique	Boquilla de plástico ajustable
-	49 00 207	101's, Deluxe's, Prof's, HD's	Brass adjustable nozzle	Buse en laiton réglable	Boquilla de latón ajustable
34	40 74 500		Clamp	Collier cpl.	Abrazadera
35	40 74 527		Elbow	Coude	Recodo
36	42 00 162	425's, 475's	Tank and frame, 4 gal.	Réservoir et cadre, 15l	Tanque y marco, 15l
-	42 00 428	435, 485	Tank and frame, 5 gal.	Réservoir et cadre, 19l	Tanque y marco, 19l
-	42 00 421	473P, 473D	Tank and frame, 3 gal.	Réservoir et cadre, 11l	Tanque y marco, 11l
37	42 00 106		Filter basket	Panier filtre	Cesta de filtro
38	43 00 315	425, 475-B	Shoulder strap (incl. 73)	Bretelle (incl. 73)	Bandolera (incl. 73)
-	43 00 340	101's, Deluxe's, HD's	Deluxe shoulder strap (incl. 73)	Bretelle de luxe (incl. 73)	Bandolera de lujo (incl. 73)
-	43 00 343	Prof's	Shouldersaver harness	Harnais de protection d'épaule	Ames de protección de hombro
39	44 00 240	HD's, Prof's, 435, 485	Pressure cylinder (incl. 107)	Chambre de pression (incl. 107)	Camara de presion (incl. 107)
-	44 00 240N	425, 475-B, 473P, 473D	Pressure cylinder	Chambre de pression	Camara de presion
40	40 73 190		Piston cylinder (incl. 12, 13, 20x2)	Cylindre de piston (incl. 12, 13, 20x2)	Cilindro del pistón (incl. 12, 13, 20x2)
41	40 74 409		Connecting rod without stud	Léviers sans goujon	Biela sin yeguada
42	40 74 270		Piston lever	Léviers de piston	Palanca del pistón
43	40 73 558		Piston	Piston	Pistón
44	44 00 189		Viton® collar	Viton® bague	Viton® anillo
45	48 00 170	425's, 473P, 435	S shut-off valve	Vanne marche /arrêt	Válvula de encendido /apagado
-	48 00 249	475's, 473D, 485	S shut-off valve (Bleach resistant)	Vanne marche /arrêt (javel)	Válvula de encendido /apagado
-	38 00 502	315-A, HD's	S shut-off valve (Viton® /FKM)	Vanne marche /arrêt (Viton®)	Válvula de encendido /apagado
46	48 00 173 25	425, 475-B, 3 & 5 gal.	Pump Lever	Léviers de pompe	Palanca de bomba
47	49 00 230		Spray tube 20", plastic (incl. 8, 26)	Tube de pulvérisation ,5m (incl. 8, 26)	Tubo rociador, 5m (incl. 8, 26)
-	49 00 645	315-A	Stainless steel wand	Tube en acier inoxydable	Varita de acero inoxidable
48	40 61345		Gasket	Joint	Sello
-	40 61346	315-A, HD's	Gasket, Viton®	Joint, Viton®	Sello, Viton®
49	00 31356		Washer	Rondelle	Arandela
50	40 74 412	473P, 473D, 435, 485	Strap buckle	Bretelle boucle	Hebilla de correa de hombro
50A	40 74 425	425's, 475's, 315-A	Strap pin	Bretelle goujon	Correa de hombro clavija
51	40 74 680		Protective cover	Couvercle de protection	Cubierta de protección
52	00 10 110		Bolt	Boulon	Tomillo
53	00 20 101		Hex. Nut	Écrou, hex.	Tuerca, hex
54	40 74 408		Connecting rod with stud	Léviers avec goujon	Biela con yeguada
55	49 00 454	101's, Deluxe's, Prof's	Fold-away pump lever (incl. 4, 56, 57, 58)	Poignée rabattable	Asa plegable
56	00 20 119		Nut	Écrou	Tuerca
57	00 12 192		Bolt	Boulon	Tomillo
58	40 74 996		Wand retaining clip	Agrafe de tube de pulvérisation	Pinza de tubo en spray
60	40 73 411		Housing, diaphragm	Boîtier, diaphragme	Cubierta, diafragma
61	40 73 412		Flange, diaphragm	Boudin, diaphragme	Brida, diafragma
63	44 00 222		Valve assy. (incl. 12, 20x2)	Ensemble de soupape (incl. 12, 20x2)	Montaje válvula (incl. 12, 20x2)
64	00 18 275		Screw, flange	Vis, boudin	Tomillo, brida
64A	00 18 275		Screw, plunger	Vis, piston	Tomillo, pistón
65	40 74 256		Plunger	Piston	Pistón
66	40 74 246		Diaphragm (Bleach resistant)	Diaphragme (javel)	Diafragma
67	40 74 255		Diaphragm lever	Léviers à diaphragme	palanca de diafragma
68	40 31130		Wrist pin	Goujon	Clavija
69	40 74 243		"L" Left connecting bracket	Gauche support	Izquierda soporte
70	40 74 234		"R" Right connecting bracket	Droite support	Derecha soporte
72	00 10 141		Bolt	Boulon	Tomillo
73	40 74 837		Strap hook	Bretelle crochet	Gancho para correa
90	27 00 316	HD's	No drip check valve	Pas de filtre goutte	Válvula de retenci
97	40 74 295		Pin	Goujon	Alfiler
98	40 61464		Vent plate	Plaque d'aération	Placa de ventilación
99	40 74 123		Vent cap	Bouchon d'aération	Tapa de ventilación
100	40 74 329		Lock clip	Clip de verrouillage	Clip de bloqueo
101	40 74 336		Retaining nut	Ecrou de raccord	Tuerca de conexión
102	40 74 335		S shut-off valve lever	Léviers de soupape	Palanca válvula
103	00 62 271		O-ring	Joint bague	Anillo de sellado
106	00 62 324		O-ring	Joint bague	Anillo de sellado
107	48 00 182	Dlx, HD's, Prof's, 435, 485	Pressure control valve (incl. 8, 23-25, 27)	Régulateur de pression	Regulador de presión (incl. 8, 23-25, 27)
Accessories					
1	42 00 215		Plug (incl. 8)	Bouchon (incl. 8)	Tapón (incl. 8)
76	49 00 430		Drift guard	Anti-dérive	Protector de la deriva
80	49 00 477		Double nozzle	Buse à double jet	Doble boquilla
93	49 00 622		Pressure gauge (incl. 94, 95)	Jauge de pression (incl. 94, 95)	Manómetro (incl. 94, 95)
94	40 74 338		Retaining nut	Ecrou de raccord	Tuerca de conexión
95	00 62 249		O-ring	Joint bague	Anillo de sellado
96	40 74 666		Speed tip nozzle	Buse à jet multiple	Boquilla de chorro múltiple
-	49 00 421		Brass wand 20"	Tube de pulvérisation en laiton	Tubo de latón
-	49 00 528		60" Brass wand 2pc	1,5m Tube de pulvérisation en laiton	1,5m Tubo de latón
-	00 65 210		Brass flatspray jet	Buse à jet plat en laiton	Boquilla de chorro plano de latón
-	06 10 410-P		Brass adjustable nozzle kit (incl. 22, 31)	Kit de buses en laiton réglable	Kit de boquilla de latón ajustable
-	49 00 513		20" plastic extension tube	,5m Tube d'extension	,5m Tubo de extensión
-	49 00 258N		Elbow nozzle assy. (incl. 10, 22, 31, 33, 35)	Ensemble de buse coudée	Juego de boquilla angulares